

# Panel Mounting Adapter Kit

For IQ 100/200 Series and PXM 2000 Meters



**EATON**

*Powering Business Worldwide*

# Panel Mounting Adapter Kit For IQ100/200 Series and PXM2000 Meters

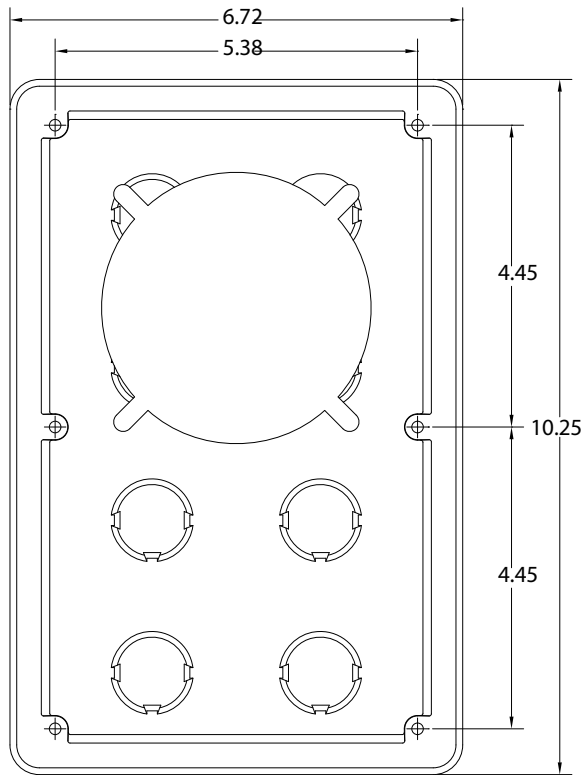

Flange Adapter Plate  
Screw Hole Pattern  
(Back View)

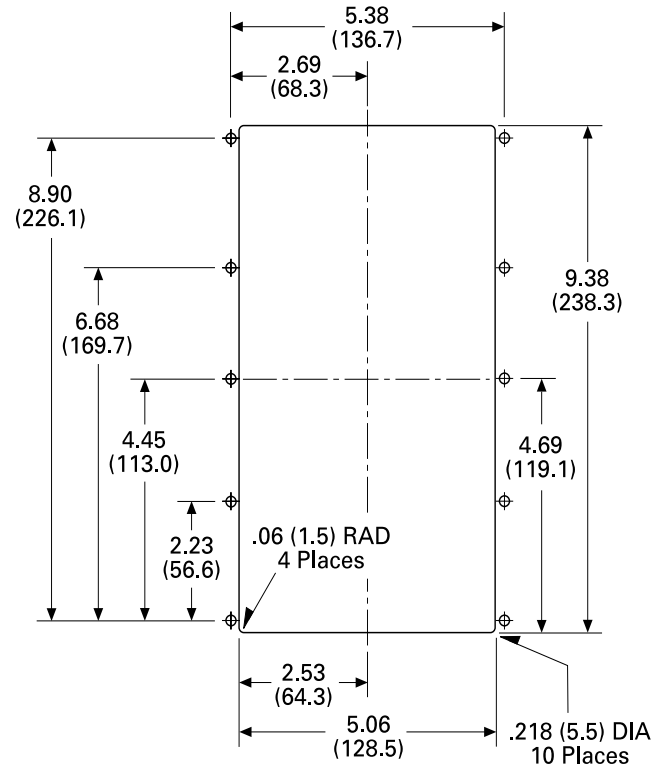

Typical IQ Flange  
Drilling Pattern

## Install the Flange Adapter Plate as follows:

- Check that the meter mounting holes in your panel match the six-hole "Flange Adapter Plate Screw Pattern" shown above. (Many IQ metering products followed a ten-hole pattern that works for the flange adapter plate).
- If not, drill six holes in the panel or door to mount the flange adapter plate. Follow the "Typical IQ Drilling Pattern" shown above. You need only the top, center, and bottom sets of holes.
- Install the flange adapter plate. Mount it from the rear using the six screws provided in the kit.
- Install the new IQ100/200 Series or PXM2000 meter in the flange adapter plate. Secure it from behind with the four flat washers, lock washers and nuts provided with the meter.

**Note:** The catalog number for the adapter kit is IQ250-PMAC. The catalog description is: PANEL MOUNTING ADAPTER KIT-IQ250 TO IQ A/DP/DATA\_ALSO WORKS WITH IQ100/200 & PXM 2000 SERIES\_.

**Eaton Corporation**  
Electrical Group  
1000 Cherrington Parkway  
Moon Township, PA 15108  
United States  
877-ETN-CARE (877-386-2273)  
Eaton.com

© 2011 Eaton Corporation  
All Rights Reserved  
Printed in USA  
Publication No. IL02601012E  
February 2011