

Service entrance & grounding fittings

Grounding fittings

GROUND CLAMP – ZINC DIE CAST

Applications:

- For bare or insulated wire or armored grounding cable

UL File No. E-6225



Cat. #	Grounding conductor electrode clamping range	Lug conductor range	Unit qty.	Wt. lbs. per 100
141DC	1/2" - 3/4", 1"	#8 - #2	25	16

GROUND CLAMP – BRONZE PLATED

Applications:

- For bare or insulated wire or armored grounding cable



Cat. #	Grounding conductor electrode clamping range	Lug conductor range	Unit qty.	Wt. lbs. per 100
141PDC	1/2" - 3/4", 1"	#8 - #2	25	16

GROUND CLAMPS – COPPER ALLOY FOR BARE WIRE

Applications:

- Used to connect bare copper wire to water pipe, re-bar, ground rod or copper water tubing for grounding
- Available with steel or bronze screws (bronze are listed for direct burial)
- Cast from high strength, highly conductive copper alloy

UL File No. E-6225



Cat. #	Grounding conductor electrode clamping range	Description	Unit qty.	Wt. lbs. per 100
GCS13	1/2" - 1"	Bare wire	100	12
GCS46	1 1/4" - 2"	Bare wire	50	30
GCS610	2 1/2" - 4"	Bare wire	12	74
GCB13	1/2" - 1"	Bronze screw direct burial	100	18

GROUND CLAMPS – COPPER ALLOY FOR ARMORED CABLE

Applications:

- Used to connect armored cable to water pipe for grounding
- Special pressure bar grips armored cable insulation to decrease chances of grounding conductor being pulled out
- Cast from high strength, highly conductive copper alloy

360 degree swivel type

- Pressure bar swings 360 degrees for easy alignment
- Assembled with zinc plated steel screws
- Cast from high strength, highly conductive copper alloy

UL File No. E-6225



Cat. #	Grounding conductor electrode clamping range	Description	Unit qty.	Wt. lbs. per 100
GCAB13	1/2" - 1"	Bronze screw direct burial	25	24
GCAS13	1/2" - 1"	360 degree swivel	25	35

Service entrance & grounding fittings

Grounding fittings

GROUND CLAMPS – COPPER ALLOY FOR RIGID CONDUIT

Applications:

- Used to connect grounding conductor in rigid conduit to water pipe for grounding
- Assembled with zinc plated steel screws
- Cast from high strength, highly conductive copper alloy

UL File No. E-6225



GCR13



GCRC13



GCRCS13

Grounding
conductor
electrode
clamping
range

Cat. #	Grounding conductor electrode clamping range	Description	Unit qty.	Wt. lbs. per 100
GCR13	1/2" - 1"	Rigid clamp	50	26
GCRC13	1/2" - 1"	Regular hub	50	26
GCRCS13	1/2" - 1"	360 degree swivel	50	26

GROUND CLAMP – COPPER ALLOY FOR RIGID OR EMT CONDUIT 360 DEGREE SWIVEL

Applications:

- Used to connect grounding conductor in rigid or EMT conduit to water pipe for grounding
- Pressure bar clamps conduit in place and swings 360 degrees for easy alignment
- Assembled with zinc plated steel screws
- Cast from high strength, highly conductive copper alloy

UL File No. E-6225



Grounding
conductor
electrode
clamping
range

Cat. #	Grounding conductor electrode clamping range	Description	Unit qty.	Wt. lbs. per 100
GCRS13	1/2" - 1"	360 degree swivel	50	26

GROUND CLAMPS – COPPER ALLOY FOR DIRECT BURIAL

Applications:

- Available in 1/2", 3/4" and 5/8" trade sizes
- Used to connect a grounding conductor to a driven ground rod
- Approved for direct burial in ground and concrete
- Assembled with bronze hexagon headed bolt
- Cast from high strength, highly conductive copper alloy

UL File No. E-6225



Grounding
conductor
electrode
clamping
range

Cat. #	Grounding conductor electrode clamping range	Description	Unit qty.	Wt. lbs. per 100
GRC1	1/2"	Regular	100	9
GRC58	5/8"	Ground rod	50	9
GRC2	3/4"	Ground rod	50	12

Service entrance & grounding fittings

Grounding fittings

LAY-IN GROUNDING LUGS

Applications:

- Designed for quick and easy installation and are used to bond wires and surfaces in grounding applications

Features:

- Allows for quick and easy installation
- Used to bond wires and surfaces in grounding applications
- Available in either aluminum or copper material to suit customer specification
- Both aluminum and copper lugs are suitable for use with copper or aluminum conductors
- Heavy duty plated slotted or hex head screw for easy installation
- Each lug accepts a range of cable sizes

Certifications and compliances:

- cULus Listed, File No. E-6225

Standard materials and finishes:

- Aluminum lay-in lug – zinc plated
- Copper lay-in lug – natural copper
- Set screw – zinc plated steel



Cat. #	Description	Conductor range	Unit qty.	Wt. lbs. per 100
LL414SA	Aluminum	#4 - #14	100	1.9
LL108SA	Aluminum	1/0 - #8 AWG	50	6.6
LL306SA	Aluminum	3/0 - #6 AWG	25	16.4
LL414C	Copper	#4 - #14 AWG	100	4.4
LL108C	Copper	1/0 - #8 AWG	50	15.9
LL306C	Copper	3/0 - #6 AWG	25	40.0

SOLAR LAY-IN GROUNDING LUGS

Applications:

- The ideal choice for the quick installation of one continuous grounding conductor or as a jumper to multiple locations
- Just unscrew the set screw, lay in the cable and re-tighten, making it easy to retrofit or repair

Features:

- Tin plated copper for additional corrosion resistance
- For use with #4-14 cable
- Stainless steel slotted screw
- Suitable for direct burial and outdoor use
- Ideal for continuous grounding of solar PV panels
- Suitable for use with copper conductors only, solid or stranded

INTERSYSTEM BONDING BRIDGES

Applications:

- Provides reliable intersystem bonding between power and communication grounding systems in commercial and residential applications

Features:

- For use in residential and commercial applications
- Can ground up to four systems to a single location
- Available in either zinc alloy or copper alloy material
- Snap-on plastic cover provides easy installation and protects from the elements
- Rated for use with solid and stranded copper conductors

Certifications and compliances:

- cULus Listed, File No. E-6225

Standard materials and finishes:

- Zinc bonding bridge – natural
- Copper bonding bridge – natural
- Screws – stainless steel
- Protective snap-on cover – plastic



Cat. #	Description	Main conductor range	Aux. Conductor range	Unit qty.	Wt. lbs. per 100
BB414DC	Zinc alloy	#6 - #2	#4 - #14	10	38.5
BB414C	Copper alloy	#6 - #2	#4 - #14	10	65.4

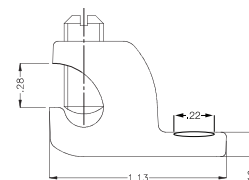
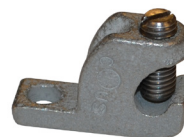

Certifications and compliances:

- cULus Listed
- UL File No. E-6225

Standard materials and finishes:

- Body – copper, tin plated
- Screw – stainless steel, natural

Cat. #	Description	Cable	Unit qty.	Wt. lbs. per 100
SLL414T	Solar grounding lug	#4-14	100	5