

PTB and PTC pull boxes (pencil boxes)

UL Listed

4E

For use in threaded rigid or IMC
conduit applications

Applications:

Pull box enclosures are installed in conduit systems (typically bridges/refineries) to:

- Act as pull and splice boxes
- Protect conductors in threaded rigid conduit
- Interconnect lengths of conduit
- Change conduit direction
- Provide access to conductors for maintenance and future system changes

Features:

- More internal cubic capacity for different sized conductors
- Accurately tapped, tapered threads (NPT) for tight, rigid joints and ground continuity
- PTB – 90° pull boxes; PTC – straight pull boxes

Certifications and compliances:

- UL Listed to UL standard 514A (see catalog number listings below)

Standard materials:

- Bodies – painted steel (RAL 7032 standard; powder coated any RAL color chip available upon request); 316L stainless steel (see standard grade catalog numbers below)
- Hubs – steel; stainless steel
- Cover bolts – 316L stainless steel

Standard finishes:

- Polyester powder coated over zinc primer
- Electro-chemical polished stainless steel

Finish options:

- Brushed stainless steel
- Polyester powder over painted stainless steel
- Natural finish stainless steel
- Polyester powder over painted carbon steel
- Galvanized carbon steel
- Zinc electroplating



Options:

Description

- Custom lengths and sizes..... **Contact factory**
- Powder coating to any RAL color chip **Contact factory**
- Supplied cable gland options **Contact factory**

Suffix

Size ranges:

- 12" through 48", hub sizes 1" to 6"

Ordering information:

Straight pull boxes

Painted steel

Cat. #	Hub size	Length
PPBPS12100TC	1"	12"
PPBPS12125TC	1 1/4"	12"
PPBPS12150TC	1 1/2"	12"
PPBPS12200TC	2"	12"
PPBPS18125TC	1 1/4"	18"
PPBPS18150TC	1 1/2"	18"
PPBPS18200TC ^A	2"	18"
PPBPS18250TC	2 1/2"	18"
PPBPS24150TC	1 1/2"	24"
PPBPS24200TC ^A	2"	24"
PPBPS24250TC	2 1/2"	24"
PPBPS24300TC ^A	3"	24"
PPBPS36250TC	2 1/2"	36"
PPBPS36300TC ^A	3"	36"
PPBPS36350TC	3 1/2"	36"
PPBPS36400TC ^A	4"	36"
PPBPS48300TC	3"	48"
PPBPS48350TC	3 1/2"	48"
PPBPS48400TC	4"	48"
PPBPS48500TC	5"	48"
PPBPS48600TC	6"	48"

316L stainless steel

Cat. #	Hub size	Length
PPBS112100TC	1"	12"
PPBS112125TC	1 1/4"	12"
PPBS112150TC	1 1/2"	12"
PPBS112200TC	2"	12"
PPBS118125TC	1 1/4"	18"
PPBS118150TC	1 1/2"	18"
PPBS118200TC	2"	18"
PPBS118250TC	2 1/2"	18"
PPBS124150TC	1 1/2"	24"
PPBS124200TC	2"	24"
PPBS124250TC	2 1/2"	24"
PPBS124300TC	3"	24"
PPBS136250TC	2 1/2"	36"
PPBS136300TC	3"	36"
PPBS136350TC	3 1/2"	36"
PPBS136400TC	4"	36"
PPBS148300TC	3"	48"
PPBS148350TC	3 1/2"	48"
PPBS148400TC	4"	48"
PPBS148500TC	5"	48"
PPBS148600TC	6"	48"

^A UL514A Listed.

PTB and PTC pull boxes (pencil boxes)

UL Listed

4E

For use in threaded rigid or IMC
conduit applications

Ordering information (continued):

90° pull boxes

Painted steel

Cat. #	Hub size	Length
PPBPS12100TB [®]	1"	12"
PPBPS12125TB	1 1/4"	12"
PPBPS12150TB	1 1/2"	12"
PPBPS12200TB	2"	12"
PPBPS18125TB	1 1/4"	18"
PPBPS18150TB [®]	1 1/2"	18"
PPBPS18200TB [®]	2"	18"
PPBPS18250TB	2 1/2"	18"
PPBPS24150TB	1 1/2"	24"
PPBPS24200TB	2"	24"
PPBPS24250TB	2 1/2"	24"
PPBPS24300TB [®]	3"	24"
PPBPS36250TB	2 1/2"	36"
PPBPS36300TB	3"	36"
PPBPS36350TB	3 1/2"	36"
PPBPS36400TB [®]	4"	36"
PPBPS48300TB	3"	48"
PPBPS48350TB	3 1/2"	48"
PPBPS48400TB	4"	48"
PPBPS48500TB	5"	48"
PPBPS48600TB	6"	48"

316L stainless steel

Cat. #	Hub size	Length
PPBS112100TB	1"	12"
PPBS112125TB	1 1/4"	12"
PPBS112150TB	1 1/2"	12"
PPBS112200TB	2"	12"
PPBS118125TB	1 1/4"	18"
PPBS118150TB	1 1/2"	18"
PPBS118200TB	2"	18"
PPBS118250TB	2 1/2"	18"
PPBS124150TB	1 1/2"	24"
PPBS124200TB	2"	24"
PPBS124250TB	2 1/2"	24"
PPBS124300TB	3"	24"
PPBS136250TB	2 1/2"	36"
PPBS136300TB	3"	36"
PPBS136350TB	3 1/2"	36"
PPBS136400TB	4"	36"
PPBS148300TB	3"	48"
PPBS148350TB	3 1/2"	48"
PPBS148400TB	4"	48"
PPBS148500TB	5"	48"
PPBS148600TB	6"	48"

Dimensions:

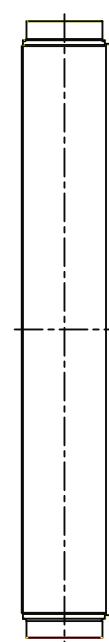
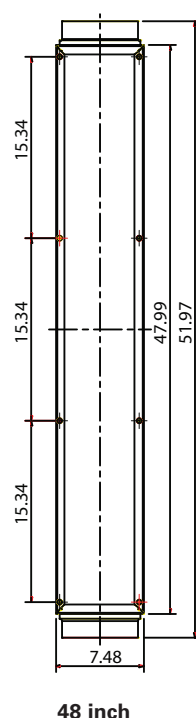
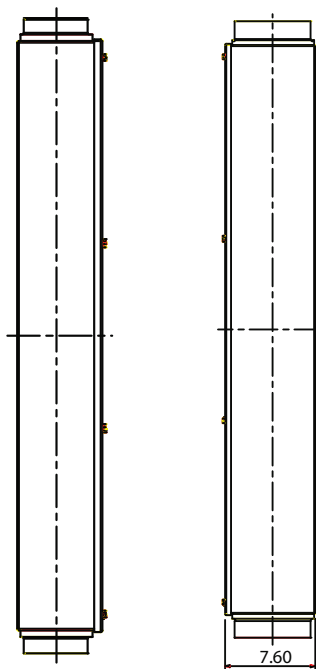
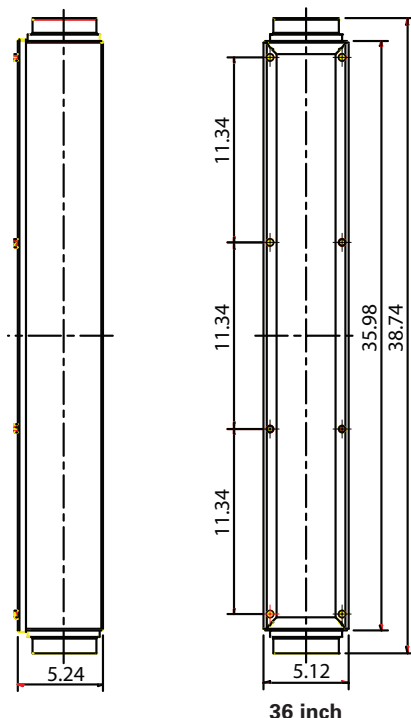
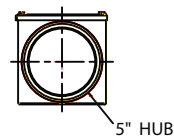
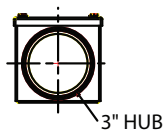

[®]UL514A Listed.