

ProPEX® Lead-free (LF) Brass Sweat Adapter

Submittal information
Revision D: Dec. 6, 2016

Project information

Job name:	
Location:	Part no. ordered:
Engineer:	Date submitted:
Contractor:	Submitted by:
Manufacturer's representative:	Approved by:

Technical data

Material: C69300 brass

Product information and application use

ProPEX® lead-free (LF) brass sweat adapters transition Uponor PEX tubing to copper pipe for use in hot and cold domestic potable water systems, residential fire safety and hydronic radiant heating and cooling systems.¹ These adapters are safe for direct burial in soil.

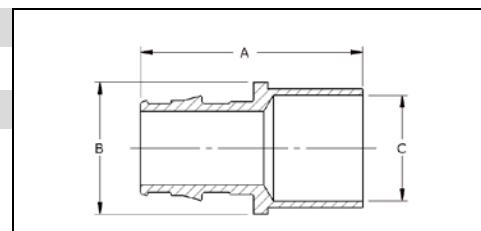

✓ Description	Part number	A	B	C	Weight	Equiv. length (ft.)	Cv
ProPEX LF Brass Sweat Adapter, 3/8" PEX x 1/2" Copper	LF4513850	1.32"	0.721"	0.625" CU	0.05 lbs.	N/A	N/A
ProPEX LF Brass Sweat Adapter, 1/2" PEX x 1/2" Copper*	LF4515050	1.44"	0.750"	0.625" CU	0.06 lbs.	2.0	5.7
ProPEX LF Brass Sweat Adapter, 1/2" PEX x 3/4" Copper	LF4515075	1.63"	0.989"	0.875" CU	0.10 lbs.	2.7	5.1
ProPEX LF Brass Sweat Adapter, 3/4" PEX x 1/2" Copper	LF4517550	1.67"	1.070"	0.625" CU	0.10 lbs.	1.4	8.8
ProPEX LF Brass Sweat Adapter, 3/4" PEX x 3/4" Copper*	LF4517575	2.04"	1.070"	0.875" CU	0.12 lbs.	2.1	13.4
ProPEX LF Brass Sweat Adapter, 3/4" PEX x 1" Copper	LF4517510	2.17"	1.258"	1.125" CU	0.17 lbs.	3.7	10.9
ProPEX LF Brass Sweat Adapter, 1" PEX x 1" Copper*	LF4511010	2.40"	1.345"	1.125" CU	0.21 lbs.	2.4	22.1
ProPEX LF Brass Sweat Adapter, 1 1/4" PEX x 1 1/4" Copper*	LF4511313	2.63"	1.640"	1.375" CU	0.35 lbs.	3.9	34.0
ProPEX LF Brass Sweat Adapter, 1 1/2" PEX x 1 1/2" Copper*	LF4511515	2.75"	1.875"	1.625" CU	0.50 lbs.	4.3	45.5
ProPEX LF Brass Sweat Adapter, 2" PEX x 2" Copper*	LF4512020	3.53"	3.000"	2.125" CU	1.00 lbs.	5.3	83.6
ProPEX LF Brass Sweat Adapter, 2 1/2" PEX x 2 1/2" Copper	LF4512525	4.60"	3.600"	2.625" CU	1.90 lbs.	6.9	136.2
ProPEX LF Brass Sweat Adapter, 3" PEX x 3" Copper	LF4513030	5.30"	4.200"	3.125" CU	2.85 lbs.	8.8	189.1

Installation

Use the appropriate Uponor ProPEX rings for the tubing (sold separately). Do not solder within 18" of ProPEX fittings. Refer to the AquaPEX® Professional Plumbing Installation Guide, Radiant Floor Heating Installation Handbook or AquaSAFE™ Residential Fire Sprinkler Installation Guide for additional information.

Standards

ASTM F877; ASTM F1960; CSA B137.5; NSF-14; NSF-61; NSF-372; *UL-1821

Codes

IBC; IRC; IPC; IMC; UPC; UMC; USEHC; NSPC; NPC of Canada

Listings

ANSI/NSF-14; ANSI/NSF-61; cNSF@us-pw-G; cNSFus-pw-G; U.P. Code; IAPMO-ER-0253; ICC-ES-PMG-1006; ICC-ES-PMG-1012; HUD-MR-1269; cQAIus P321; *cNSF@us-pw-fs-G; *UL-1821; *ULC/ORD-C199P

Related applications

PEX plumbing systems
Radiant heating and cooling systems
Snow and ice melting systems
Permafrost protection systems
Turf conditioning systems
AquaSAFE fire safety systems

Contact information

Uponor Inc.
5925 148th Street West
Apple Valley, MN 55124 USA
T 800.321.4739
F 952.891.2008
uponorpro.com

Uponor Ltd.
2000 Argenta Rd., Plaza 1, Ste. 200
Mississauga, ON L5N 1W1 CANADA
T 888.994.7726
F 800.638.9517
uponorpro.com

¹ProPEX® is a registered trademark of Uponor, Inc. ProPEX™ is a trademark of Uponor Ltd.