

SMC™-3 Smart Motor Controllers

Approximate Dimensions

Dimensions in millimeters (inches). Dimensions are not intended to be used for manufacturing purposes. All dimensions are subject to change.

Open Type

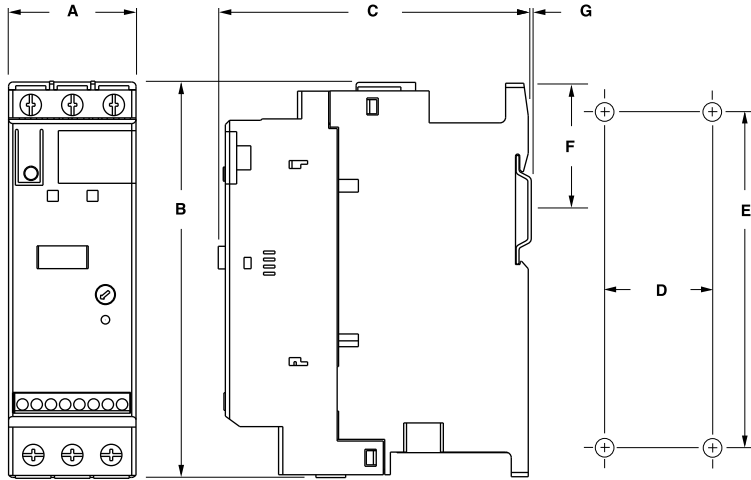

4

Controller Rating [A]	A	B	C	D	E	F	G	Mounting Hole Size	Weight kg (lbs)
1...37	44.8 (1-49/64)	139.7 (5-1/2)	100 (4-21/64)	35 (1-3/8)	132 (5-13/64)	46.4 (1.81)	2 (1/16)	4.6 (0.18)	0.86 (1.9)
43...85	72 (2.83)	206 (8.11)	130 (5.12)	55 (2.17)	198 (7.8)	102 (4.02)	2 (1/16)	5.3 (0.21)	2.25 (5.0)
108...135	196.4 (7.74)	443.7 (17.47)	205.2 (8.08)	166.6 (6.56)	367 (14.45)	—	—	7.5 (0.295)	15 (33)
201...251	225 (8.86)	560 (22.05)	265.3 (10.45)	150 (5.91)	504.1 (19.85)	—	—	11.5 (0.45)	30.4 (67)
317...480	290 (11.42)	600 (23.62)	298 (11.73)	200 (7.87)	539.2 (21.23)	—	—	11.5 (0.45)	45.8 (101)

Minimum Enclosure Size

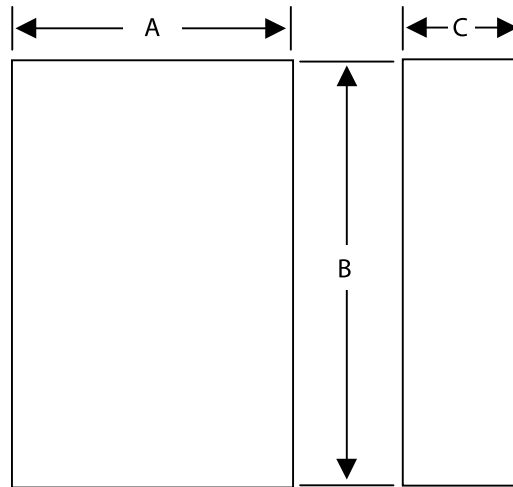

Controller Rating [A]	B Height	A Width	C Depth	Fan Requirements
1...37 A	305 (12)	224 (9)	152 (6)	none
43...85 A	406 (16)	305 (12)	203 (8)	none
108...135 A	762 (30)	610 (24)	305 (12)	none
201...251 A	965 (38)	762 (30)	356 (14)	none
317...480 A	1295 (51)	914 (36)	356 (14)	none

Enclosed Type Line-Connected Controllers

Dimensions in millimeters (inches). Dimensions are not intended to be used for manufacturing purposes. All dimensions are subject to change.

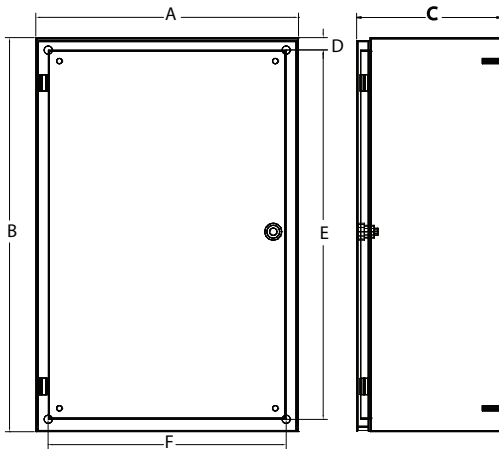

Figure 1 — Wall-Mount

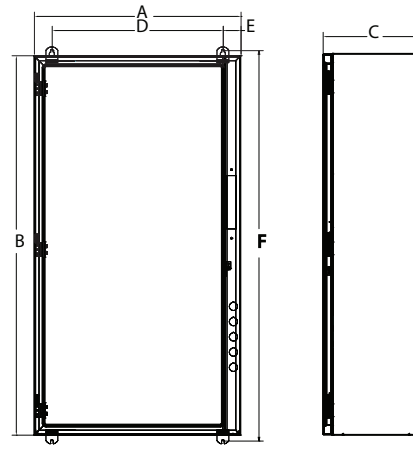

Figure 2 — Wall-Mount

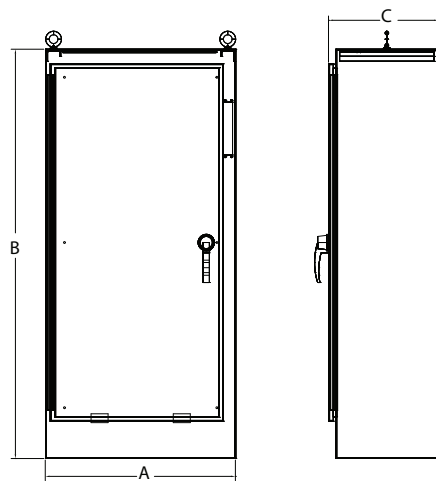

Figure 3 — Floor-Mount

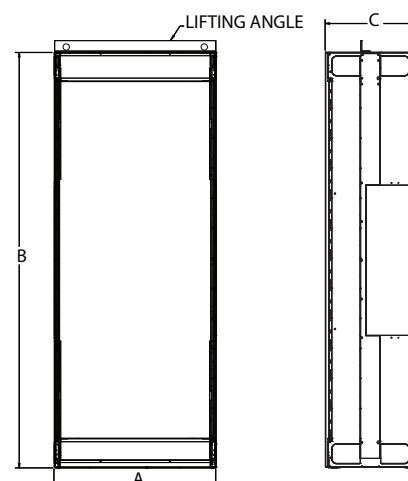

Figure 4 — Floor-Mount

Controller Rating [A]	Bulletin	With Option	Dimension Figure No.	Dimensions in inches (mm)					
				A (Width)	B (Height)	C (Depth)	D (Mtg. Dim.)	E (Mtg. Dim.)	F (Mtg. Dim.)
SMC-3 Non-Combination Controller									
3...37	150	—	1	8 (203)	12 (305)	6 (152)	2.44 (62)	10.43 (265)	3.0 (76)
		6P		12 (305)	12 (305)	6 (152)	2.41 (61)	10.43 (265)	7.0 (178)
43...85	150	—	1	8 (203)	14 (356)	8 (203)	2.44 (62)	12.40 (315)	3.0 (76)
		—		16 (406)	14 (356)	8 (203)	4.38 (111)	12.40 (315)	7.0 (178)
108...135	150	Any	1	24 (610)	30 (762)	12 (305)	0.75 (19)	28.5 (724)	22.5 (572)
201...251	150	—	1	30 (762)	38 (965)	14 (356)	0.75 (19)	36.5 (927)	28.5 (724)
	150, 150B	BP,NB,NI,6P		36 (914)	51 (1295)	14 (356)	0.75 (19)	49.5 (1257)	34.5 (876)
317...361	150B	Any	1	36 (914)	51 (1295)	14 (356)	0.75 (19)	49.5 (1257)	34.5 (876)
		—		36 (914)	51 (1295)	14 (356)	0.75 (19)	49.5 (1257)	34.5 (876)
		NI, 6P		36 (914)	51 (1295)	14 (356)	0.75 (19)	49.5 (1257)	34.5 (876)
		BP,NI, 6P		36 (914)	60 (1524)	14 (356)	0.75 (19)	58.5 (1486)	34.5 (876)
480	150	—	1	36 (914)	51 (1295)	14 (356)	0.75 (19)	49.5 (1257)	34.5 (876)
	150, 150B	BP,NB,NI,6P		36 (914)	60 (1524)	14 (356)	0.75 (19)	58.5 (1486)	34.5 (876)

Controller Rating [A]	Bulletin	With Option	Dimension Figure No.	Dimensions in inches (mm)					
				A (Width)	B (Height)	C (Depth)	D (Mtg. Dim.)	E (Mtg. Dim.)	F (Mtg. Dim.)
SMC-3 Combination Controller									
3...37	152H,153H	Any	1	16 (406)	14 (356)	8 (203)	4.38 (111)	12.40 (315)	7.0 (178)
43	152H	Any	1	16 (406)	14 (356)	8 (203)	4.38 (111)	12.40 (315)	7.0 (178)
	153H	Any	1	16 (406)	24 (610)	10 (254)	0.75 (19)	22.5 (572)	14.5 (368)
60	152H, 153H	Any	1	16 (406)	24 (610)	9 (229)	0.75 (19)	22.5 (572)	14.5 (368)
	152H	Any	1	24 (610)	30 (762)	12 (305)	0.75 (19)	28.5 (724)	22.5 (572)
85	152H	Any	1*	16 (406)	24 (610)	9 (229)	0.75 (19)	22.5 (572)	14.5 (368)
		Any	1*	24 (610)	30 (762)	12 (305)	0.75 (19)	28.5 (724)	22.5 (572)
	153H	Any	1	16 (406)	24 (610)	9 (229)	0.75 (19)	22.5 (572)	14.5 (368)
108	152H,153H	Any	1	30 (762)	38 (965)	14 (356)	0.75 (19)	36.5 (927)	28.5 (724)
	152B,153B	Any	1	36 (914)	51 (1295)	14 (356)	0.75 (19)	49.5 (1257)	34.5 (876)
135	152H,153H	Any	1	30 (762)	38 (965)	14 (356)	0.75 (19)	36.5 (927)	28.5 (724)
	152B,153B	Any	1	36 (914)	51 (1295)	14 (356)	0.75 (19)	49.5 (1257)	34.5 (876)
201	152H,153H	—	1	30 (762)	38 (965)	14 (356)	0.75 (19)	36.5 (927)	28.5 (724)
	152B,153B, 152H,153H	Any	1	36 (914)	51 (1295)	14 (356)	0.75 (19)	49.5 (1257)	34.5 (876)
251	152H,153H	—	1	30 (762)	38 (965)	14 (356)	0.75 (19)	36.5 (927)	28.5 (724)
	152B,153B, 152H,153H	Any	1	36 (914)	51 (1295)	14 (356)	0.75 (19)	49.5 (1257)	34.5 (876)
317	153H	—	1	36 (914)	51 (1295)	14 (356)	0.75 (19)	49.5 (1257)	34.5 (876)
		BP,NB	1	36 (914)	60 (1524)	14 (356)	0.75 (19)	58.5 (1486)	34.5 (876)
	153B	—	1	36 (914)	60 (1524)	14 (356)	0.75 (19)	58.5 (1486)	34.5 (876)
	152B,152H	—	2	38 (965)	60 (1524)	17 (431)	33.88 (861)	1.75 (45)	61.69 (1567)
	152H	BP	2	38 (965)	60 (1524)	17 (431)	33.88 (861)	1.75 (45)	61.69 (1567)
	152B,152H,153B,153H	NB,NI	3	40 (1016)	84 (2134)	18 (457)	—	—	—
361	153H	—	1	36 (914)	51 (1295)	14 (356)	0.75 (19)	49.5 (1257)	34.5 (876)
		BP,NB	1	36 (914)	60 (1524)	14 (356)	0.75 (19)	58.5 (1486)	34.5 (876)
	153B	—	1	36 (914)	60 (1524)	14 (356)	0.75 (19)	58.5 (1486)	34.5 (876)
	152B,152H	—	2	38 (965)	60 (1524)	17 (431)	33.88 (861)	1.75 (45)	61.69 (1567)
	152H	BP	2	38 (965)	60 (1524)	17 (431)	33.88 (861)	1.75 (45)	61.69 (1567)
	152B,152H,153B,153H	NB,NI	3	40 (1016)	84 (2134)	18 (457)	—	—	—
480	153H	—	1	36 (914)	51 (1295)	14 (356)	0.75 (19)	49.5 (1257)	34.5 (876)
		BP	3§	40 (1016)	84 (2134)	18 (457)	—	—	—
	152H,153B	Any	3	40 (1016)	84 (2134)	18 (457)	—	—	—
	152H	—	4§	20 (508)	91.5 (2324)	20 (508)	—	—	—
	152B, 152H	BP,NB	4§	35 (889)	91.5 (2324)	20 (508)	—	—	—

* Rating 20 Hp @208V, 25 Hp @240V, 50 Hp @ 480V, 60 Hp @ 600V

⊛ Rating 25 Hp @208V, 30 Hp @240V, 60 Hp @ 480V, 75 Hp @ 600V

§ 200 Hp @ 240V AC, 400 Hp @480V, 500 Hp @ 600V

