

Efficient Cable Management and Installation

Hubbell Premise Wiring's VME Series Vertical Cable Managers provide efficient and effective cable management to support and secure your cabling infrastructure and ensure optimal network performance in today's Mission Critical[®] applications. The VME vertical managers build on the features and design of the VM series and are updated with targeted front and rear capacity for mid to large size cabling requirements to optimize storage space with overall footprint. The VME is designed to maximize installation efficiency during both assembly to the relay rack and cabling. Durable metal construction ensures cables are protected and supported throughout their life cycle. The VME managers provide an efficient solution to manage your end-to-end Hubbell Premise Wiring cabling system.

Specifications

- 80.5" height for 84"/45 RU racks and frames
- 6" wide, 14" overall depth
- Steel construction with aluminum doors
- Front: C-shaped 6" W x 7.23" D-channel with L-shaped cable guides every 2 RU
- Rear: (5) 6" W x 6.3" D cable rungs and (6) 6" D spools
- Front cover included with all units; VME614C2 includes full height rear cover; VME614C1 includes swinging gate covers for the rear rungs



Features

- Front cable guides spaced every two rack units make it easier to route patch cables, align with two rack unit panels/horizontal managers, and improve air flow while effectively managing and supporting the cables
- Cable guides welded to the frame for strength
- In the rear, open design helps route cable bundles, ensures good air flow, and allows flexibility to deploy management where you need it
- Hinging covers reversible to hinge left or right
- Front to back pass thru openings at any height
- VME flush mounts with HM 4" horizontals for a clean appearance

Installation Efficiency

- Unpack and install in two to three minutes
- Main channel ships fully assembled
- Simple, quick component assembly
- Quick attach hooks secure the manager in place while bolting it to the rack
- Covers and swing gates hinge out of the way during cabling
- Cable management design and features make it easier to route cables



VME Series Vertical Cable Managers

Vertical Cable Managers

7'H x 6"W x 14"D; front C channel

Description	Color	Catalog No.
(5) rear cable rungs; (6) spools; front and rear cover	Black	VME614C2
(5) rear cable rungs; (6) spools; front cover, rear gate covers	Black	VME614C1

Capacity

Front Area: 39 in²; Rear Area: 30 in²

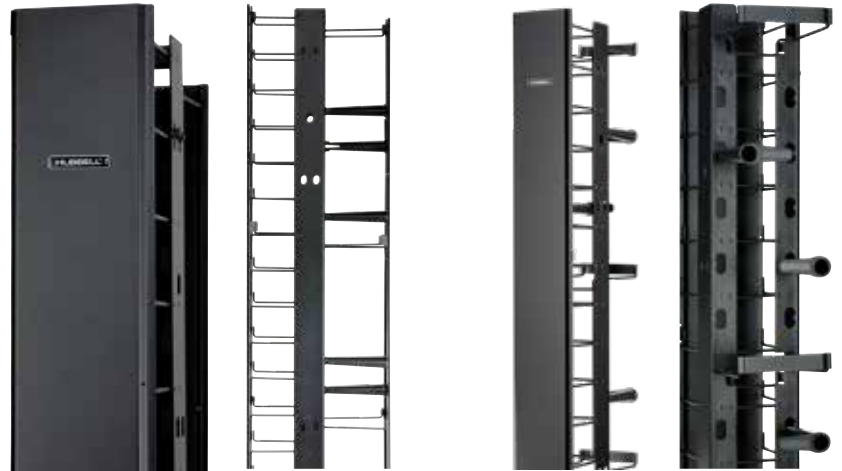
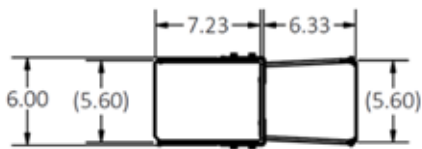

VME614C2

VME614C1

Compatible Relay Racks and Server Frames

3" Deep, 45 RU Relay Rack	HPW84RR19
6" Deep, 45 RU Relay Rack	HPW84RR19D
10" Extra Deep, 45 RU Relay Rack	HHR45U10
16" Extra Deep, 45 RU Relay Rack	HHR45U16
SF84 Series 4 Post Racks	SF8419yy*

Standard M6 cage nut

*Add **T** for #12-24 Threaded

yy = Depth (in) (**24, 29, 36, 42, 48**)



Suggested Horizontal Cable Managers

VME Flush Mount with HM 4" Front Depth

RU	Description	Catalog No.
1	4" front depth, hinging front cover	HM14C
2	4" front depth, hinging front cover	HM24C
2	4" front, 7" rear depth, hinging front cover	HM247C



Accessories

Description	Catalog No.
VME Series, 7'H x 6"W cover, Black	VME6C
VME Series rear gate kit (5)	VME614GK

VME Series Fill Chart

	HCL Patch Cords 0.19" OD	HC6 Patch Cords 0.23" OD	HC6A Patch Cords 0.29" OD	Cat 6 Link 0.20" OD	Cat 6 Mid 0.225" OD	Cat 6A 0.27" OD
VME Front Channel C Shaped Channel, 38.9 sq in	536	370	232	486	389	268
VME Rear Channel Rungs and Gates, 30.2 sq in	416	287	180	377	302	208

40% Fill Rate Capacity